

a m e r i c a n d r e w™

P R  F I L E S

f u r n i t u r e d e s i g n e d f o r l i v i n g



a m e r i c a n  d r e w®
a L A Z B O Y® company

4310 Regency Drive, Suite 101
High Point, NC 27265
www.americandrew.com
© 2010 by American Drew

AD/FCC/WCP/06-10/5M

C A M D E N L I G H T F I N I S H
S E R I E S 9 2 0

Subtle style references and approachable scale enable you to reflect a unique sense of personal style while satisfying your desire for comfort, convenience, and quality. And, like a clean canvas, PROFILES invites an infinite range of accessorization, allowing you to add the accessories and personal possessions that express who you are, fashioning the perfect home for your individual life.

That's what PROFILES is all about—
 furniture that fits your life!



CAMDEN LIGHT FINISH

Camden accents simple forms with quiet traditional references, gentle curves and a beautiful time worn white finish that lets the character of the wood show through. The brushed nickel finish hardware adds even more casual elegance to Camden. This collection will work great in your renovated farm house or that smaller beach cottage get-away.

920-595
 DESK - RTA
 W51 D22 H31

920-636
 SPLAT SIDE CHAIR
 W20 D24 H39
 Seat H20



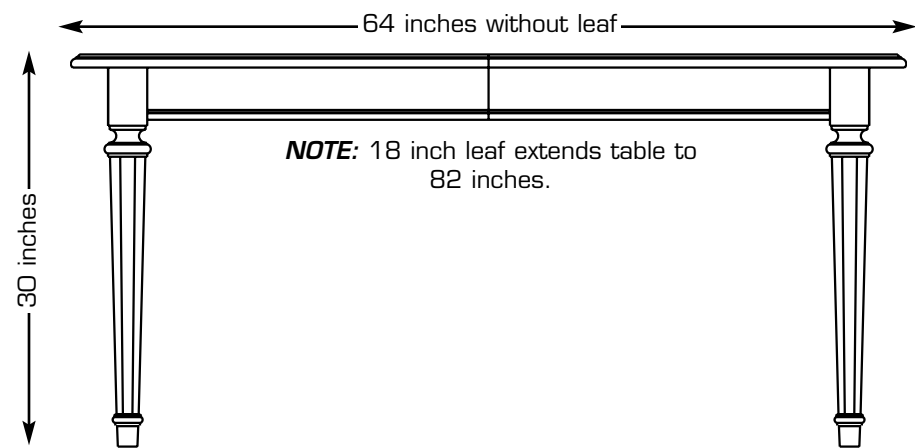

920-760
LEG TABLE



Table Top Detail
Without Leaf



Table Top Detail
With Leaf

Right:
920-636
SPLAT SIDE CHAIR - KD
W20 D24 H39
Seat H20

920-637
SPLAT ARM CHAIR - KD
W23 D24 H39
Seat H20 Arm H25

920-760
LEG TABLE - RTA
L64 W42 H30
(1) 18" Leaf
Extends Table to 82"
(Shown with leaf)

920-830R
CHINA
W63 D20 H82
Consists of:
-831 China Deck
W63 D20 H48
-830 China Buffet/Credenza
W60 D19 H34

"We love to cook
and have friends
over and the
Camden Leg
Table seats us all
comfortably."





Above:
920-015
ROUND MIRROR
 W39 D3 H39
 Beveled Mirror.

920-890
SERVER
 W40 D18 H38
 2 Drawers, 1 Pullout Shelf,
 1 Door with 1 Adjustable
 Shelf, Stationary Wine
 Storage, Silver Tray.



Right:
920-830R
CHINA
 W63 D20 H82
 Consists of:

-831 China Deck
 W63 D20 H48
 3 Doors, 6 Adjustable Glass Shelves,
 3 Can Lights, Mirrored Back,
 Touch Lighting.
-830 China Buffet/Credenza
 W60 D19 H34
 2 Glass Doors with 1 Adjustable Glass
 Shelf in Each, 3 Drawers, Silver Tray,
 2 Can Lights, Touch Lighting.



Above & Left:
920-582
FLIP TOP BAR
 W39 D22 H43
 (99 x 56 x 109cm)
 2 Doors, Bottle Storage,
 1 Drawer, Wine Storage,
 Black Laminate on Flip Top,
 Casters on Bottom.

920-706R
ROUND BAR HEIGHT PED
TABLE

L42 W42 H41

Consists of:

-706 Round Table Top

L42 W42 H4

-B02 Bar Height Ped Table

Base - RTA

W32 D32 H40

920-691

BAR STOOL - BAR HEIGHT - KD

W18 D21 H45

Seat H30



**920-890
SERVER**

W40 D18 H38
2 Drawers, 1 Pullout Shelf,
1 Door with 1 Adjustable
Shelf, Stationary Wine
Storage, Silver Tray.

**920-707R
ROUND COUNTER HEIGHT
PED TABLE**

L42 W42 H35

Consists of:

-706 Round Table Top

L42 W42 H4

**-B03 Counter Height Ped
Table Base - RTA**

W32 D32 H34

**920-690
BAR STOOL - COUNTER
HEIGHT - KD**

W18 D21 H39

Seat H25



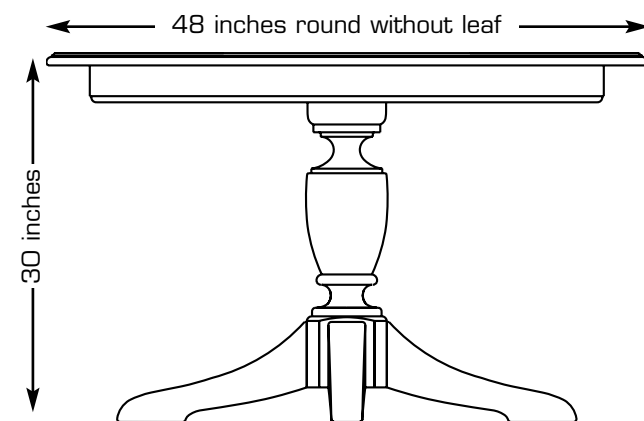

920-701R
ROUND TABLE

NOTE: 16 inch leaf extends
table to 64 inches..



Table Top Detail
Without Leaf



Table Top Detail
With Leaf

Right:
920-015
ROUND MIRROR
W39 D3 H39
Beveled Mirror.

920-890
SERVER
W40 D18 H38
2 Drawers, 1 Pullout Shelf,
1 Door with 1 Adjustable
Shelf, Stationary Wine
Storage, Silver Tray.

920-701R
ROUND TABLE
L48 W48 H30
(1) 16" Leaf
Extends Table to 64".
(Shown with leaf)

920-636
SPLAT SIDE CHAIR
W20 D24 H39
Seat H20



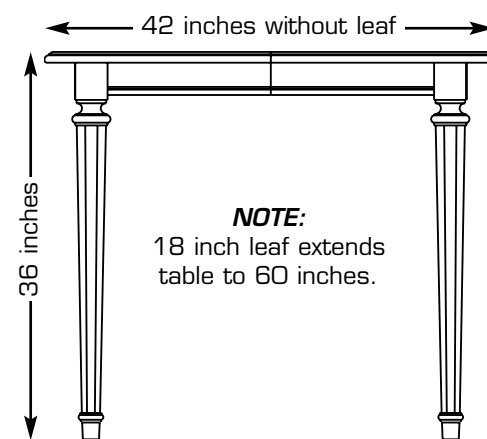

Table Top Detail
Without Leaf



Table Top Detail
With Leaf

NOTE: The 705 Gathering Table
can make a great office desk set
up as well.



**920-705
GATHERING TABLE**

Right:
**920-705
GATHERING TABLE**
L60 W42 H36
(1) 18" Leaf
Extends Table to 60" x 60"
(Shown without leaf)

**920-690
BAR STOOL - COUNTER
HEIGHT - KD**
W18 D21 H39
Seat H25

**920-588
BOOKCASE/CHINA**
W52 D19 H80



"I love my Camden
Gathering Table for
Casual dining or set
up with my laptop as
a home work area, it
fits both perfectly."





Left:
920-691
BAR STOOL -
BAR HEIGHT - KD
 W18 D21 H45
 Seat H30

920-690
BAR STOOL -
COUNTER HEIGHT - KD
 W18 D21 H39
 Seat H25



Left:
920-636
SPLAT SIDE CHAIR - KD
 W20 D24 H39
 Seat H20

920-637
SPLAT ARM CHAIR - KD
 W23 D24 H39
 Seat H20
 Arm H25

Right:
920-589
BOOKCASE/BAR
 W38 D18 H42
 2 Drawers, Glass Fold Up
 Door with Wine Glass
 Storage on LSF, Open
 Compartment on RSF, Glass
 Fold Up Door with Removable
 Wine Rack on Bottom.



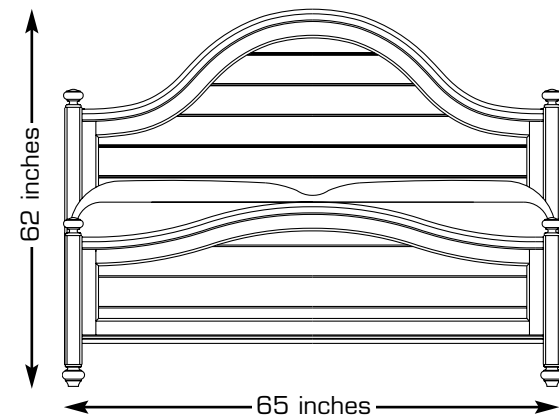

**920-313R
PANEL BED 5/0**

NOTE: Panel Bed Available in
Additional Sizes.
See Page 47 for details.

Right:

**920-313R
PANEL BED 5/0**

Consists of:

- 313 Panel Headboard 4/6-5/0**
W65 D4 H62
- 314 Panel Footboard 4/6-5/0**
W65 D4 H29
- R42 Wooden Rails 5/0-6/6**
W82 D2 H8
- SK1 Mattress Support System**

**920-401
LEG NIGHTSTAND - RTA**

W26 D19 H28
1 Drawer, 1 Shelf, Pullout Shelf
with Black Laminate.



Right:
920-215
DRAWER CHEST
 W38 D19 H52
 5 Drawers.



“Camden creates
 that relaxed feel I
 want in
 my bedroom.”

Right:
920-230
CORNER CHEST
 W42 D20 H50
 5 Drawers.



920-020
LANDSCAPE MIRROR
 W41 D2 H36
 Beveled Mirror.

920-220
DRESSING CHEST
 W62 D20 H39
 9 Drawers.



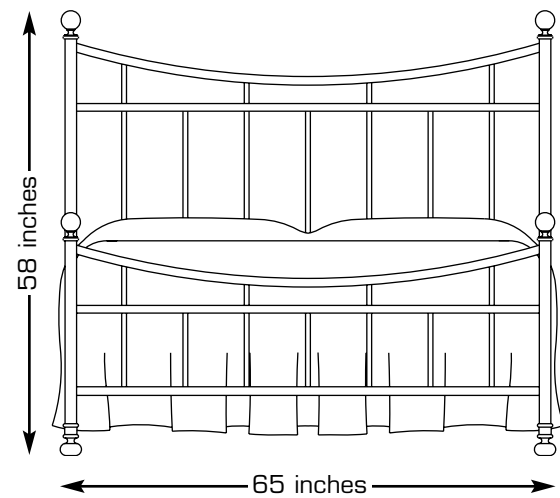

920-395NR
METAL BED 5/O
NICKEL FINISH

NOTE: Metal Bed Available in
 Additional Sizes.
 See Page 47 for details.

Right:
920-395NR
METAL BED 5/O
NICKEL FINISH

Consists of:
-395N Metal Bed 5/O
 W65 D3 H58
-R95N Metal Rails 5/O
 W82 D2 H8

920-401
LEG NIGHTSTAND - RTA
 W26 D19 H28
 1 Drawer, 1 Shelf, Pullout Shelf
 with Black Laminate.



Right:
920-015
ROUND MIRROR
W39 D3 H39
Beveled Mirror.

920-221
DRESSER
W56 D19 H37
7 Drawers.

920-310R
PANEL BED 3/3
Consists of:
-310 Panel Headboard 3/3
W43 D3 H53
Bored for Frame.
-311 Panel Footboard 3/3
W43 D3 H28
-R40 Wood Rails with
Slats 3/3
W76 D2 H8

920-401
LEG NIGHTSTAND - RTA
W26 D19 H28
1 Drawer, 1 Shelf, Pullout Shelf
with Black Laminate.

NOTE: Panel Bed Available in
Additional Sizes.
See Page 47 for details.



Right:
920-401
LEG NIGHTSTAND - RTA
W26 D19 H28
1 Drawer, 1 Shelf, Pullout Shelf
with Black Laminate.

920-390NR
METAL BED 3/3
NICKEL FINISH

Consists of:
-390N Metal Bed 3/3
W43 D3 H58
-R90N Metal Rails 5/0
W76 D2 H8

920-015
ROUND MIRROR
W39 D3 H39
Beveled Mirror.

920-221
DRESSER
W56 D19 H37
7 Drawers.

NOTE: Metal Bed Available in
Additional Sizes.
See Page 45 for details.





**920-270R
ARMOIRE**
Shown as Storage.



**920-270R
ARMOIRE**
Shown with Hanging Rod.



**920-270R
ARMOIRE**
Shown as Entertainment.



**920-270R
ARMOIRE**
W46 D24 H73
Consists of:
-271 Armoire Deck
W46 D24 H48
2 Wraparound Doors,
2 Adjustable Shelves,
Clothes Rod, Sliding
Back Panel, 1 Fixed
Shelf, 2 Open
Compartments:
W19 D19 H6
TV Outlet Box.
TV Opening:
W39 D20 H37
-270* Armoire Base
W43 D22 H25
5 Drawers.

Right:
920-910
COCKTAIL TABLE
W48 D24 H19
2 Pull Through Drawers,
4 Baskets.

920-915
SIDE TABLE
W23 D20 H25
2 Drawers, 1 Basket.



“Bright and airy,
comfy and casual,
that is what we like
and Camden fits
that.”





Above:
920-401
LEG NIGHTSTAND - RTA
 W26 D19 H28
 1 Drawer, 1 Shelf, Pullout
 Shelf with Black Laminate.

NOTE: Nightstands and End
 Tables can be interchanged.

Above:
920-915
SIDE TABLE
 W23 D20 H25
 2 Drawers, 1 Basket.

Right:
920-925
CONSOLE TABLE
 W48 D16 H30
 4 Drawers,
 4 Baskets,
 2 Adjustable Shelves.



Left:
920-940
WALL STORAGE - RTA
 W34 D19 H76
 5 Shelves.



“The scale of Camden was perfect for our home and we did not have to sacrifice the style we wanted.”

Left:
920-585
48" ENTERTAINMENT CENTER
 W48 D24 H28
 2 Doors with Adjustable Shelf
 Behind Each, 2 Adjustable
 Shelves and 1 Fixed Shelf in
 Center.



920-588
BOOKCASE/CHINA
 W52 D19 H80
 2 Sliding Doors, 2 Tray
 Drawers, 3 Adjustable Glass
 Shelves, 2 Can Lights.

NOTE: The 588 Bookcase/China works well in an occasional or dining area.



NOTE: Multiple pieces used to create a full wall unit.

Overall Dimensions as shown:
Width: 112"
Depth: 22"
Height: 75"

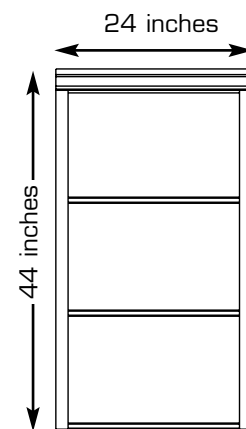

**920-581
END UNIT TOP**

NOTE: Two 920-581 End Unit Tops used.

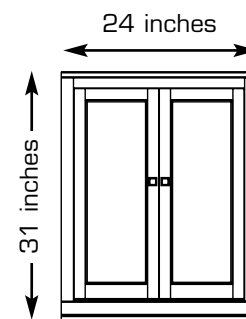

**920-580
END UNIT BASE**

NOTE: Two 920-580 End Unit Bases used.

Right:

920-581

END UNIT TOP

W24 D17 H44

2 Adjustable Wooden Shelves,
1 Fixed Shelf.
(2 Shown)

920-580

END UNIT BASE

W24 D22 H31

2 Doors with 2 Adjustable Half
Shelves Behind Each.
(2 Shown)

920-583

64" ENTERTAINMENT CENTER

W64 D22 H25

2 Doors with Fixed Half Shelf
Behind Each, 2 Adjustable
Shelves and 1 Fixed Shelf in
Center.

920-591

64" STORAGE BRIDGE

W64 D17 H14

3 Open Compartments.

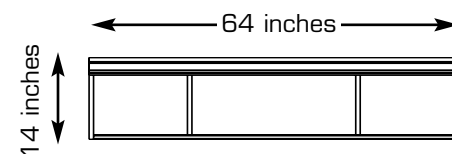

**920-591
STORAGE BRIDGE**

NOTE: Storage Bridge offered
in smaller size as 920-590.
See Page 35 for details.

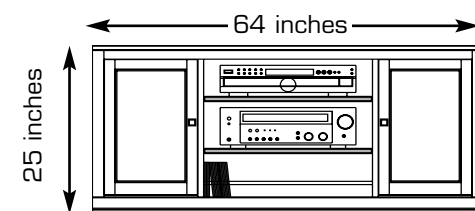

**920-583
64" ENTERTAINMENT CENTER**

NOTE: Entertainment Center offered
in smaller size as 920-584.
See Page 47 for details.





Above:
920-586
64" ENTERTAINMENT CENTER
 W64 D24 H28
 2 Double Doors with 1
 Adjustable Shelf Behind Each,
 2 Adjustable Shelves and
 1 Fixed Shelf in Center.

NOTE: Camden offers multiple options
 and sizes for Entertainment pieces.



Above:
920-940
WALL STORAGE - RTA
 W34 D19 H76
 5 Shelves.

920-946
56" ENTERTAINMENT CENTER - RTA
 W56 D23 H29
 2 Fixed Shelves,
 Top Opening: W52 D19 H7
 Bottom Opening: W52 D22 H13



Above & Right:
920-942
HOME WORK STATION
 W48 D23 H39
 3 Drawers, Fold Down Front
 Center Drawer, Pencil Tray,
 Power Bar, 2 Doors with 3
 Tray Drawers Behind Each,
 File Storage in Each Bottom
 Drawer.

920-943
HOME WORK STATION DECK
 W51 D15 H44
 4 Bi-Fold Doors with 3
 Adjustable Shelves, Removable
 Charging Station, Power Bar,
 Wire Management. Openings:
 Top: W11 D12 H16
 Center Top: W21 D12 H8
 Bottom LSF: W17 D16 H14

920-690
BAR STOOL -
COUNTER HEIGHT - KD
 W18 D21 H39
 Seat H25



Right:
920-581
END UNIT TOP
W24 D17 H44
2 Adjustable Wooden Shelves,
1 Fixed Shelf.
(2 Shown)

920-580
END UNIT BASE
W24 D22 H31
2 Doors with 2 Adjustable Half
Shelves Behind Each.
(2 Shown)

920-592
LIGHT BRIDGE
W51 D18 H3
2 Can Light System.

920-595
DESK - RTA
W51 D22 H31
1 Drawer with Removable
Pencil Box, Power Bar Mounted
in Top, Finished Back.

920-941
FILE/DRAWER CABINET
W16 D22 H24
4 Casters, 2 Drawers,
File Storage in
Bottom Drawer.

920-636
SPLAT SIDE CHAIR
W20 D24 H39
Seat H20





Right & Below:
920-945
DROP LID WORK STATION
 W44 D21 H48
 Drop Down Door,
 LSF: 2 Drawers, Divided
 Compartment,
 Opening: W5 D13 H5,
 Center: 1 Adjustable Shelf,
 Opening: W14 D13 H16,
 Power Bar, Wire Management,
 RSF: 1 Drawer, Divided
 Compartment,
 Opening: W3 D13 H10,
 4 Drawers, 2 Doors with
 Removable Shelf Behind Each,
 Wire Management,
 File Storage in
 Bottom Center Drawer.



Above & Bottom Left:
920-944
HOME OFFICE CABINET
 W48 D25 H60
 2 Doors, LSF: 1 Adjustable Shelf,
 Top Opening: W27 D20 H24
 1 Fixed Shelf, Pull Out Keyboard Tray,
 Pull Out Printer Tray in Bottom, Cork
 Board on Inside Door Panel.
 Opening: W27 D20 H16
 Power Bar.
 RSF: 2 Adjustable Shelves,
 Top Opening: W13 D20 H28
 1 Fixed Shelf, 2 Drawers, Pencil Tray
 in Top Drawer, File Storage in Bottom
 Drawer, Wire Management, Magnetic
 Dry Erase Board on Inside Door
 Panel.



CAMDEN

LIGHT FINISH



920 WHITE COLOR FINISH

POPLAR SOLIDS, MAPLE, ASH VENEERS AND SELECT HARDWOODS

Finishes ordered at different times are not guaranteed to match. Woods have grain and color variations due to growth patterns of each tree. The result is a beautiful and unique piece. Due to these variations, finishes on individual pieces are not guaranteed to match. The finish shown here has been reproduced as accurately as photographic and printing technologies allow.

For the truest representation, please contact your American Drew dealer.

CARE & CLEANING

CARE OF FINE FINISHES

American Drew finishes are naturally resistant to minor everyday hazards and accidents; however, some precautions are necessary to maintain the beauty of your wood furniture.

- Dust with a soft clean cloth slightly moistened with water, and then dry completely with another clean cloth. Always rub in the direction of the wood grain.
- Avoid cigarettes, hot dishes, moisture and harsh solvents such as nail polish and alcohol.
- Do not place beverages directly on furniture.
- Use pads beneath accessories when writing or eating.
- Remove spills and smudges immediately.
- Pliable materials should not be left on a wood surface; they can damage the finish.
- Furniture should not be placed near heat, outlets, windows, or in direct sunlight.

CARE OF DECORATIVE HARDWARE

The decorative hardware on this furniture has been protected with a clear lacquer coat. The use of harsh detergents or brass polish in an attempt to clean or obtain higher luster will result in the removal of the protective lacquer and will damage the finish of the hardware. Use a soft damp cloth to remove dust.

All illustrations and specifications in this catalog are based on the latest product information available at the time of printing. American Drew reserves the right to discontinue items without notice and to make changes to colors, materials, equipment and specifications at any time. Quotes contained in this catalog are from fictional consumers. This catalog is intended to be distributed to authorized dealers, and possession does not constitute authority to purchase.

* Indicates: Cannot be sold separately.
"R" Indicates merchandise shipped in more than one carton and must be used to order complete item.

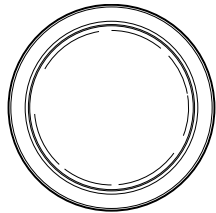

920-015
ROUND MIRROR
W39 D3 H39 (99 x 8 x 99cm)
Beveled Mirror.
Mirror Supports Not Included.
Pages: 6, 12/13, 24/25, 26/27

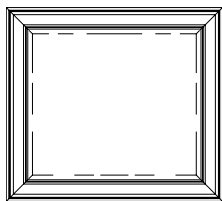

920-020
LANDSCAPE MIRROR
W41 D2 H36 (104 x 5 x 91cm)
Beveled Mirror.
Mirror Supports Not Included.
Can be used vertical or horizontal.
Page: 21

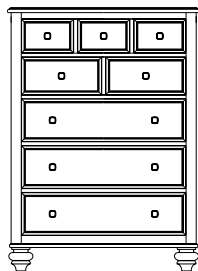

920-215
DRAWER CHEST
W38 D19 H52
(97 x 48 x 132cm)
5 Drawers.
Page: 20

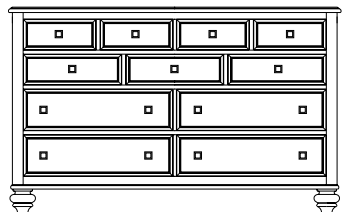

920-220
DRESSING CHEST
W62 D20 H39
(157 x 51 x 99cm)
9 Drawers.
Page: 21

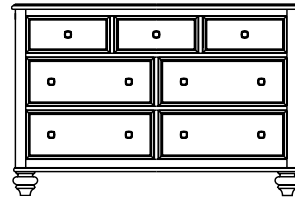

920-221
DRESSER
W56 D19 H37
(142 x 48 x 94cm)
7 Drawers.
Pages: 24/25, 26/27

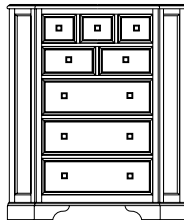

920-230
CORNER CHEST
W42 D20 H50
(107 x 66 x 127cm)
5 Drawers.
Page: 20

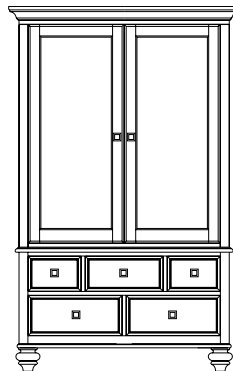

920-270R
ARMOIRE
W46 D24 H73
(117 x 61 x 185cm)
Consists of:

-271 Armoire Deck
W46 D24 H48
(117 x 61 x 122cm)
2 Wraparound Doors,
2 Adjustable Shelves,
Clothes Rod, Sliding Back
Panel, 1 Fixed Shelf,
2 Open Compartments:
W19 D19 H6
(48 x 48 x 15cm)
TV Outlet Box.
TV Opening:
W39 D20 H37
(99 x 51 x 94cm)

-270* Armoire Base
W43 D22 H25
(109 x 56 x 64cm)
5 Drawers.
Pages: 28/29

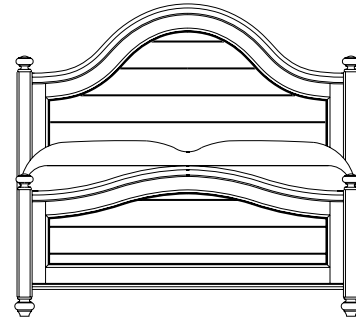

920-310R
PANEL BED 3/3

Consists of:

-310 Panel Headboard 3/3
W43 D3 H53
(109 x 8 x 135cm)
Bored for Frame.

-311 Panel Footboard 3/3
W43 D3 H28
(109 x 8 x 71cm)

-R40 Wood Rails with Slats 3/3
W76 D2 H8
(193 x 5 x 20cm)

Pages: 24/25

920-313R
PANEL BED 5/0

Consists of:

-313 Panel Headboard 4/6 - 5/0
W65 D4 H62
(165 x 10 x 157cm)
Bored for Frame.

-314 Panel Footboard 4/6 - 5/0
W65 D4 H29
(165 x 10 x 74cm)

-R42 Wooden Rails 5/0 - 6/6
W82 D2 H8
(208 x 5 x 20cm)

-SK1 Mattress Support System
Pages: 18/19

Available in additional sizes:

920-312R
PANEL BED 4/6

Consists of:

-313 Panel Headboard 4/6 - 5/0
W65 D4 H62
(165 x 10 x 157cm)
Bored for Frame.

-314 Panel Footboard 4/6 - 5/0
W65 D4 H29
(165 x 10 x 74cm)

-R41 Wooden Rails 4/6
W76 D2 H8
(193 x 5 x 20cm)

-SK1 Mattress Support System

920-316R
PANEL BED 6/6

Consists of:

-316 Panel Headboard 6/6 - 6/0
W83 D4 H66
(211 x 10 x 168cm)
Bored for Frame.

-317 Panel Footboard 6/6 - 6/0
W83 D4 H30
(211 x 10 x 76cm)

-R42 Wooden Rails 5/0 - 6/6
W82 D2 H8
(208 x 5 x 20cm)

-SK1 Mattress Support System

920-317R
PANEL BED 6/0

Consists of:

-316 Panel Headboard 6/0 - 6/6
W83 D4 H66
(211 x 10 x 168cm)
Bored for Frame.

-317 Panel Footboard 6/0 - 6/6
W83 D4 H30
(211 x 10 x 76cm)

-R44 Wooden Rails 6/0
W86 D2 H8
(218 x 5 x 20cm)

-SK1 Mattress Support System

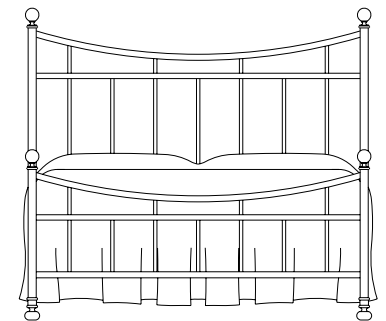

920-390R
METAL BED COMPLETE 3/3
BRUSHED NICKEL FINISH

Consists of:

-390 Metal Bed 3/3
W43 H58 Footboard H32 (81cm)
(109 x 147cm)

-R90 Metal Rails 3/3
W76 D2 H8
(193 x 5 x 20cm)

Pages: 26/27

920-395NR
METAL BED 5/0 - BRUSHED NICKEL FINISH

Consists of:

-395N Metal Bed 5/0
W65 H58 Footboard H32 (81cm)
(102 x 102cm)

-R95N Metal Rails 5/0
W82 D2 H8
(208 x 5 x 20cm)

Pages: 22/23

Available in additional sizes:

920-393NR
METAL BED 4/6 - BRUSHED NICKEL FINISH

Consists of:

-393N Metal Bed 4/6
W58 H58 Footboard H32 (81cm)
(102 x 102cm)

-R93N Metal Rails 4/6
W76 D2 H8
(193 x 5 x 20cm)

920-398NR
METAL BED 6/6 - BRUSHED NICKEL FINISH

Consists of:

-398N Metal Bed 6/6
W81 H61 Footboard H34 (86cm)
(206 x 155cm)

-R98N Metal Rails 6/6
W82 D2 H8
(208 x 5 x 20cm)

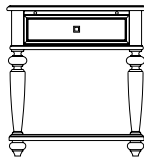

920-401
LEG NIGHTSTAND - RTA
 W26 D19 H28 (66 x 48 x 71cm)
 1 Drawer, 1 Fixed Shelf,
 Pull Out Shelf with Black Laminate.
 Pages: 18/19, 22/23, 24/25,
 26/27, 32

*Please use the following when
 ordering frames and mirror supports:*
920-M71
TWO MIRROR SUPPORTS

920-095
METAL FRAME FOR 4/6 OR 5/O
HEADBOARDS ONLY

920-096
METAL FRAME FOR 6/6
HEADBOARD ONLY

920-097
METAL FRAME FOR 6/O
HEADBOARD ONLY

Chairs noted as shipped KD require
 assembly.
 -636 & -637 packed 2 per carton.
 Service charge of \$10.00
 for recartoning will apply when one chair
 is ordered.
 -690 & -691 packed 1 per carton.
 COM ORDERS NOT ACCEPTED.

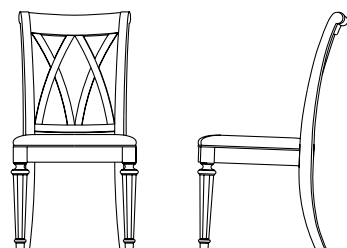

920-636
SPLAT SIDE CHAIR - KD
 W20 D24 H39 (51 x 61 x 99cm)
 Seat H20 (51cm)
 Pages: 3, 4/5, 12/13, 16, 42/43

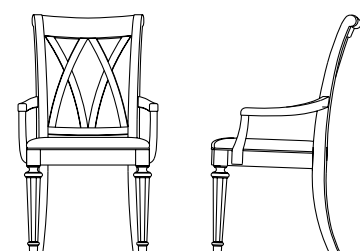

920-637
SPLAT ARM CHAIR - KD
 W23 D24 H39 (58 x 61 x 99cm)
 Seat H20 (51cm)
 Arm H25 (64cm)
 Pages: 4/5, 16

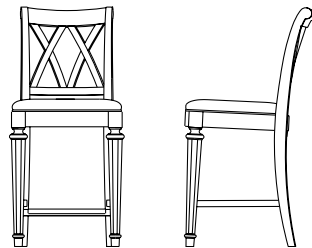

920-690
BAR STOOL - COUNTER HEIGHT - KD
 W18 D21 H39 (46 x 53 x 99cm)
 Seat H25 (64cm)
 Pages: 10/11, 14/15, 16, 41

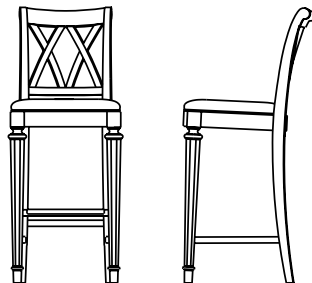

920-691
BAR STOOL - BAR HEIGHT - KD
 W18 D21 H45 (46 x 53 x 114cm)
 Seat H30 (76cm)
 Pages: 9, 16

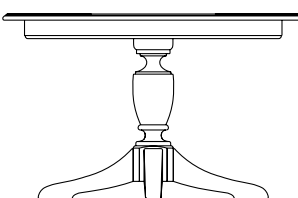

920-701R
ROUND LEG TABLE
 L48 W48 H30 (123 x 123 x 76cm)
 (1) 16" (41cm) Leaf
 Extends Table to 64" (163cm)
Consists of:
-701 Round Table Top
 L48 W48 H4 (123 x 123 x 10cm)
-B01 Table Base
 W37 D37 H27 (94 x 94 x 69cm)
 Pages: 12/13

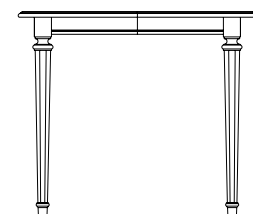

920-705
GATHERING TABLE - RTA
 L60 W42 H36 (152 x 107 x 91cm)
 (1) 18" (46cm) Leaf
 Extends Table to 60" (152cm)
 Pages: 14/15

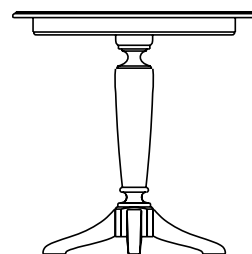

920-706R
ROUND BAR HEIGHT PED TABLE
 L42 W42 H41 (107 x 107 x 104cm)
Consists of:
-706 Round Table Top
 L42 W42 H4 (107 x 107 x 10cm)
-B02 Bar Height Ped Table Base - RTA
 W32 D32 H40 (94 x 94 x 102cm)
 Page: 9

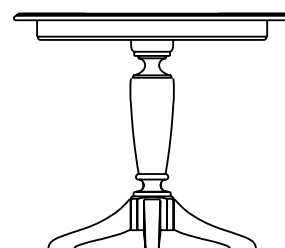

920-707R
ROUND COUNTER HEIGHT PED TABLE
 L42 W42 H35 (107 x 107 x 89cm)
Consists of:
-706 Round Table Top
 L42 W42 H4 (107 x 107 x 10cm)
-B03 Counter Height Ped Table Base - RTA
 W32 D32 H34 (94 x 94 x 86cm)
 Pages: 10/11

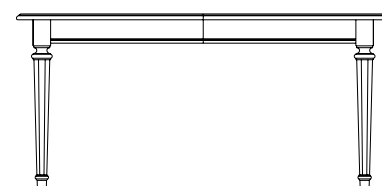

920-760
LEG TABLE - RTA
 L64 W42 H30 (163 x 107 x 76cm)
 (1) 18" (46cm) Leaf
 Extends Table to 82" (208cm)
 Pages: 4/5

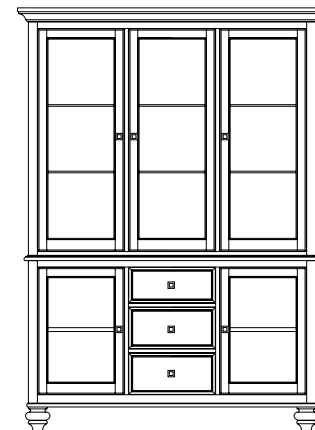

920-830R
CHINA
 W63 D20 H82 (160 x 51 x 208cm)
Consists of:
-831 China Deck
 W63 D20 H48 (160 x 51 x 122cm)
 3 Doors, 6 Adjustable Glass Shelves, 3
 Can Lights, Mirrored Back, Touch
 Lighting.
 Pages: 4/5, 7

-830 China Buffet/Credenza
 W60 D19 H34 (152 x 48 x 86cm)
 2 Glass Doors with 1 Adjustable Glass
 Shelf in Each, 3 Drawers, Silver Tray, 2
 Can Lights, Touch Lighting.
 Pages: 4/5, 7

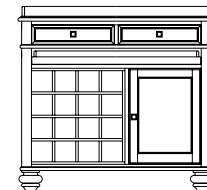

920-890
SERVER
 W40 D18 H38 (102 x 46 x 97cm)
 2 Drawers, 1 Pullout Shelf,
 1 Door with 1 Adjustable Shelf,
 Stationary Wine Storage, Silver Tray.
 Pages: 6, 10/11, 12/13

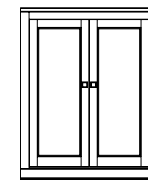

920-580
END UNIT BASE
 W24 D22 H31
 (61 x 56 x 79cm)
 2 Doors with 2 Adjustable Half Shelves
 Behind Each.
 Pages: 36/37, 42/43

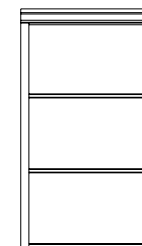

920-581
END UNIT TOP
 W24 D17 H44
 (61 x 43 x 112cm)
 2 Adjustable Wooden Shelves,
 1 Fixed Shelf.
 Pages: 36/37, 42/43

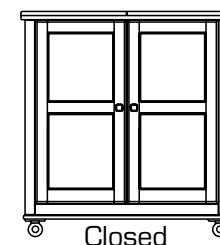

Closed

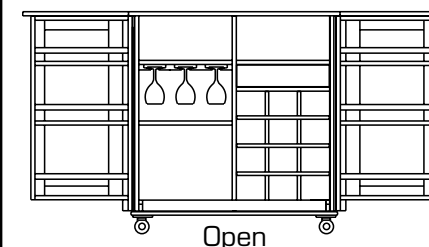

Open

920-582
FLIP TOP BAR
 W39 D22 H43
 (99 x 56 x 109cm)
 2 Doors, Bottle Storage, 1 Drawer, Wine
 Storage, Black Laminate on Flip Top,
 Casters on Bottom.
 TOP LSF: W17 D16 H18
 (43 x 41 x 46cm)
 TOP RSF: W17 D16 H8
 (43 x 41 x 20cm)
 BOTTOM LSF: W17 D16 H14
 (43 x 41 x 36cm)

Page: 8

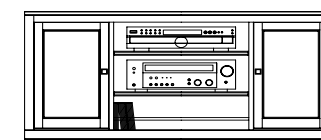

920-583
64" ENTERTAINMENT CENTER
 W64 D22 H25
 (163 x 56 x 64cm)
 2 Doors with Fixed Half Shelf
 Behind Each, 2 Adjustable Shelves
 and 1 Fixed Shelf in Center.
 Pages: 36/37

920-584
51" ENTERTAINMENT CENTER
 W51 D22 H25
 (130 x 56 x 64cm)
 2 Doors with Fixed Half Shelf
 Behind Each, 2 Adjustable Shelves
 and 1 Fixed Shelf in Center.
 Not Shown. Reference pages 36/37.

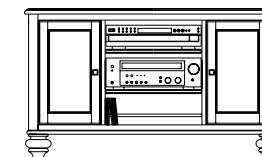

920-585
48" ENTERTAINMENT CENTER
 W48 D24 H28
 (123 x 61 x 71cm)
 2 Doors with Adjustable Shelf
 Behind Each, 2 Adjustable Shelves
 and 1 Fixed Shelf in Center.
 Page: 34

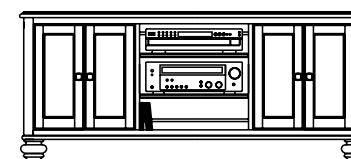

920-586
64" ENTERTAINMENT CENTER
 W64 D24 H28
 (163 x 61 x 71cm)
 2 Double Doors with 1 Adjustable Shelf
 Behind Each, 2 Adjustable Shelves
 and 1 Fixed Shelf in Center.
 Opening Behind Doors:
 W19 D21 H19 (48 x 53 x 48cm)
 Center Opening:
 W20 D21 H19 (51 x 53 x 48cm)
 Page: 38

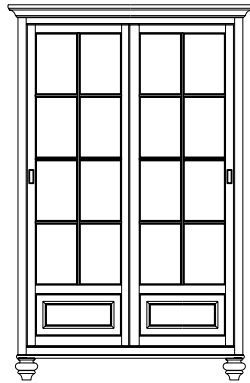

920-588
BOOKCASE/CHINA
W52 D19 H80
(132 x 48 x 203cm)
2 Sliding Doors, 2 Tray Drawers, 3
Adjustable Glass Shelves, 2 Can Lights.
Pages: 14/15, 35

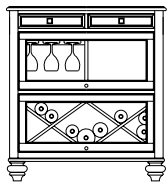

920-589
BOOKCASE/BAR
W38 D18 H42
(97 x 46 x 107cm)
2 Drawers, Glass Fold Up Door
with Wine Glass Storage on LSF,
Open Compartment on RSF, Glass Fold
Up Door with Removable Wine Rack
on Bottom.
Page: 17



920-590
51" STORAGE BRIDGE
W51 D17 H14 (130 x 43 x 36cm)
3 Open Compartments.
Left & Right Outsides:
W12 D16 H10 (30 x 41 x 25cm)
Center:
W24 D16 H10 (61 x 41 x 25cm)
Not Shown. Reference pages 36/37.



920-591
64" STORAGE BRIDGE
W64 D17 H14 (163 x 43 x 36cm)
3 Open Compartments.
Left & Right Outsides:
W17 D16 H10 (43 x 41 x 25cm)
Center:
W28 D16 H10 (71 x 41 x 25cm)
Pages: 36/37



920-592
LIGHT BRIDGE
W51 D18 H3
(130 x 46 x 8cm)
2 Can Light System.
Pages: 42/43

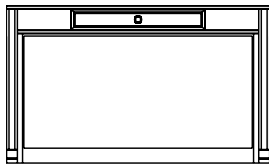

920-595
DESK - RTA
W51 D22 H31
(130 x 56 x 79cm)
1 Drawer with Removable Pencil Box,
Power Bar Mounted in Top, Finished Back.
Pages: 3, 42/43

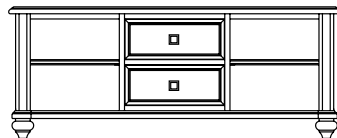

920-910
COCKTAIL TABLE
W48 D24 H19
(122 x 61 x 48cm)
2 Pull Through Drawers,
4 Baskets.
Pages: 30/31



920-915
SIDE TABLE
W23 D20 H25
(58 x 51 x 64cm)
2 Drawers, 1 Basket.
Pages: 30/31, 32

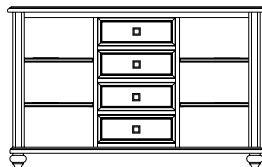

920-925
CONSOLE TABLE
W48 D16 H30
(122 x 41 x 76cm)
4 Drawers, 4 Baskets,
2 Adjustable Shelves.
Page: 33

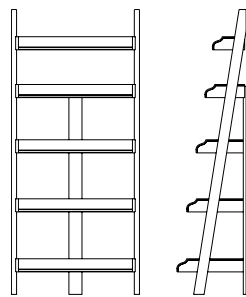

920-940
WALL STORAGE - RTA
W34 D19 H76
(86 x 48 x 193cm)
5 Shelves.
Pages: 34, 39



920-941
FILE/DRAWER CABINET
W16 D22 H24
(41 x 56 x 61cm)
4 Casters, 2 Drawers, File Storage in
Bottom Drawer.
Pages: 42/43

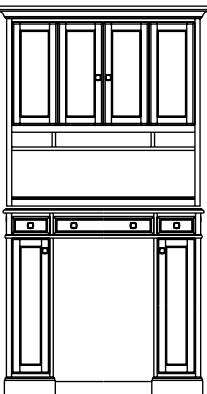

920-942
HOME WORK STATION
W48 D23 H39
(122 x 58 x 99cm)
3 Drawers, Fold Down Front Center
Drawer, Pencil Tray, Power Bar, 2 Doors
with 3 Tray Drawers Behind Each, File
Storage in Each Bottom Drawer.
Pages: 38/39

920-943
HOME WORK STATION DECK
W51 D15 H44
(130 x 38 x 112cm)
4 Bi-Fold Doors with 3 Adjustable Shelves,
Removable Charging Station, Power Bar,
Wire Management. Openings:
Top: W11 D12 H16
(28 x 30 x 41cm)
Center Top: W21 D12 H8
(53 x 30 x 20cm)
Bottom LSF: W17 D16 H14
(43 x 41 x 36cm)
Pages: 40/41

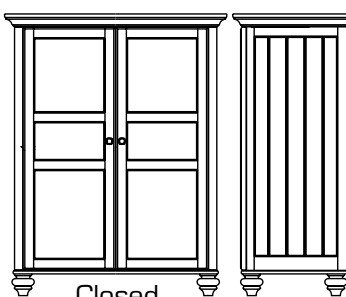

Closed

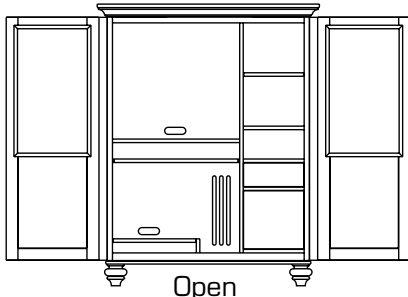

Open

920-944
HOME OFFICE CABINET
W48 D25 H60
(122 x 64 x 152cm)
2 Doors, LSF: 1 Adjustable Shelf Top,
Opening: W27 D20 H24
(69 x 51 x 61cm)
1 Fixed Shelf, Pull Out Keyboard Tray,
Pull Out Printer Tray in Bottom.
Opening: W27 D20 H16
(69 x 51 x 41cm)
Power Bar, Cork Board on Inside Door Panel.
RSF: 2 Adjustable Shelves,
Top Opening: W13 D20 H28
(33 x 51 x 71cm)
1 Fixed Shelf, 2 Drawers, Pencil Tray in
Top Drawer, File Storage in Bottom
Drawer, Wire Management, Magnetic
Dry Erase Board on Inside Door Panel.
Page: 44

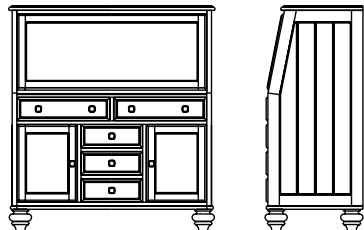

920-945
DROP LID WORK STATION
W44 D21 H48
(112 x 53 x 122cm)
Drop Down Door, LSF: 2 Drawers, Divided
Compartment,
Opening: W5 D13 H5 (13 x 33 x 13cm),
Center: 1 Adjustable Shelf,
Opening: W14 D13 H16 (36 x 33 x 41cm),
Power Bar, Wire Management,
RSF: 1 Drawer, Divided Compartment,
Opening: W3 D13 H10 (8 x 33 x 25cm),
4 Drawers, 2 Doors with Removable Shelf
Behind Each, Wire Management, File
Storage in Bottom Center Drawer.
Page: 44/45

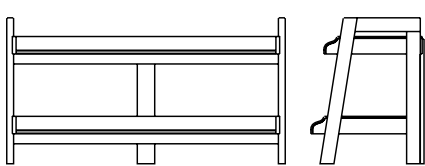

920-946
56" ENTERTAINMENT CENTER - RTA
W56 D23 H29 (142 x 58 x 74cm)
2 Fixed Shelves,
Top Opening: W52 D19 H7
(132 x 48 x 18cm)
Bottom Opening: W52 D22 H13
(132 x 56 x 33cm)
Page: 39